

- NOTES:**
1. Materials, forms and covers to be constructed by same contractor.
 2. All work shall be done in accordance with the specifications of the City of San Bernardino.
 3. All work shall be done in accordance with the specifications of the City of San Bernardino.
 4. All work shall be done in accordance with the specifications of the City of San Bernardino.
 5. All work shall be done in accordance with the specifications of the City of San Bernardino.
 6. All work shall be done in accordance with the specifications of the City of San Bernardino.

[Signature]
E. L. BELL

DEPARTMENT OF ENGINEER
CITY OF SAN BERNARDINO
IMPROVEMENT PLANS & PROFILES
TRACT NO. 4905

DESIGNED BY: *[Signature]*
DRAWN BY: *[Signature]*
CHECKED BY: *[Signature]*
REGISTERED CIVIL ENGINEER NO. 9879

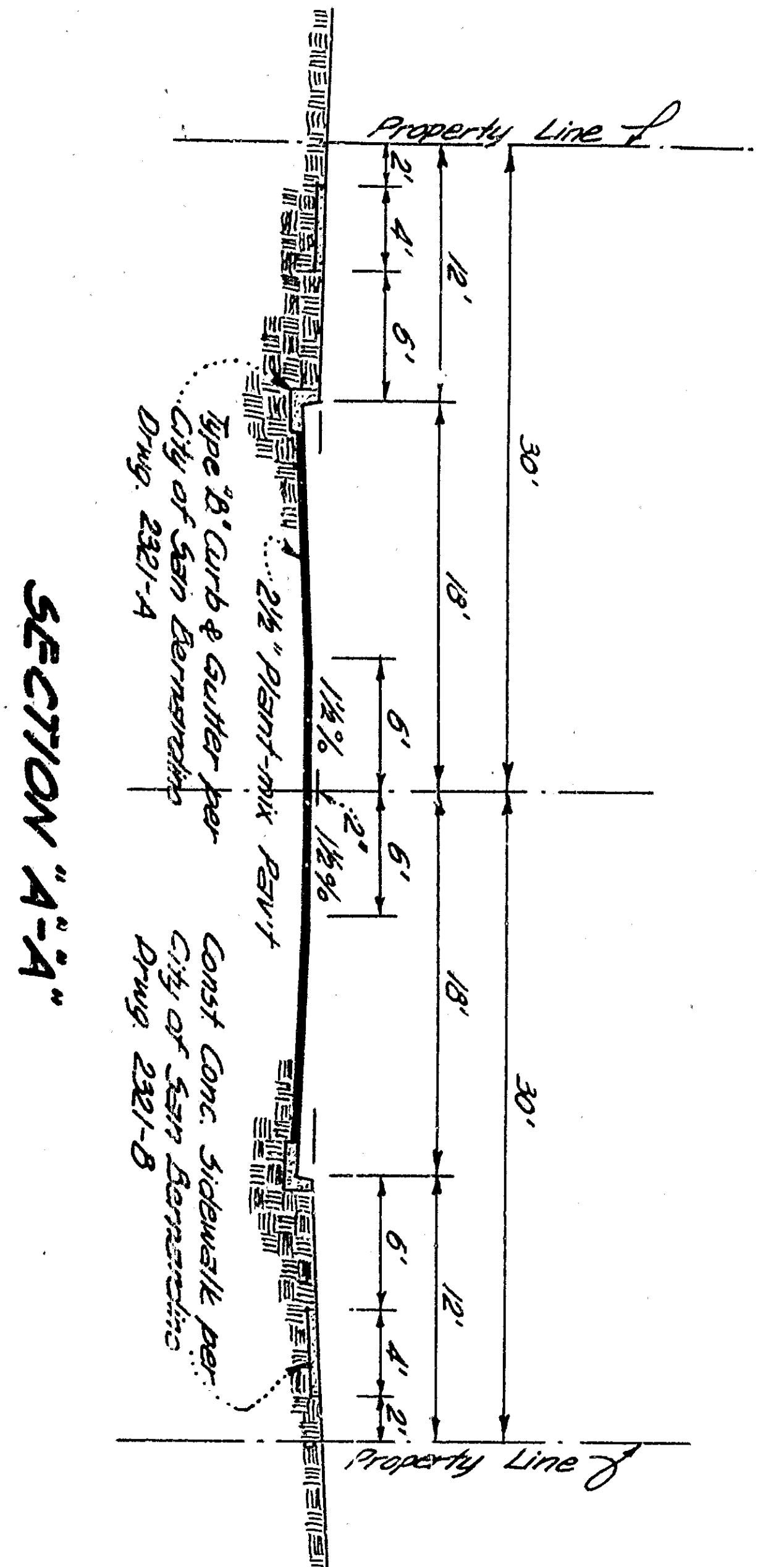
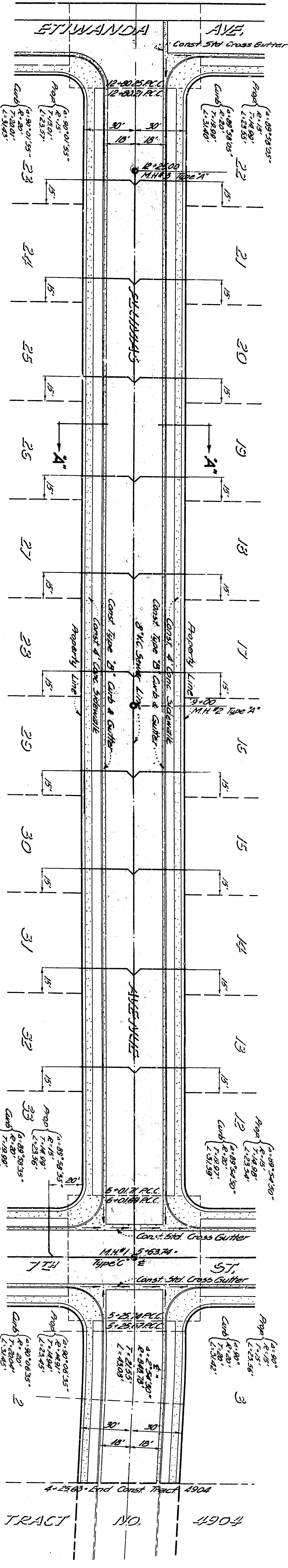
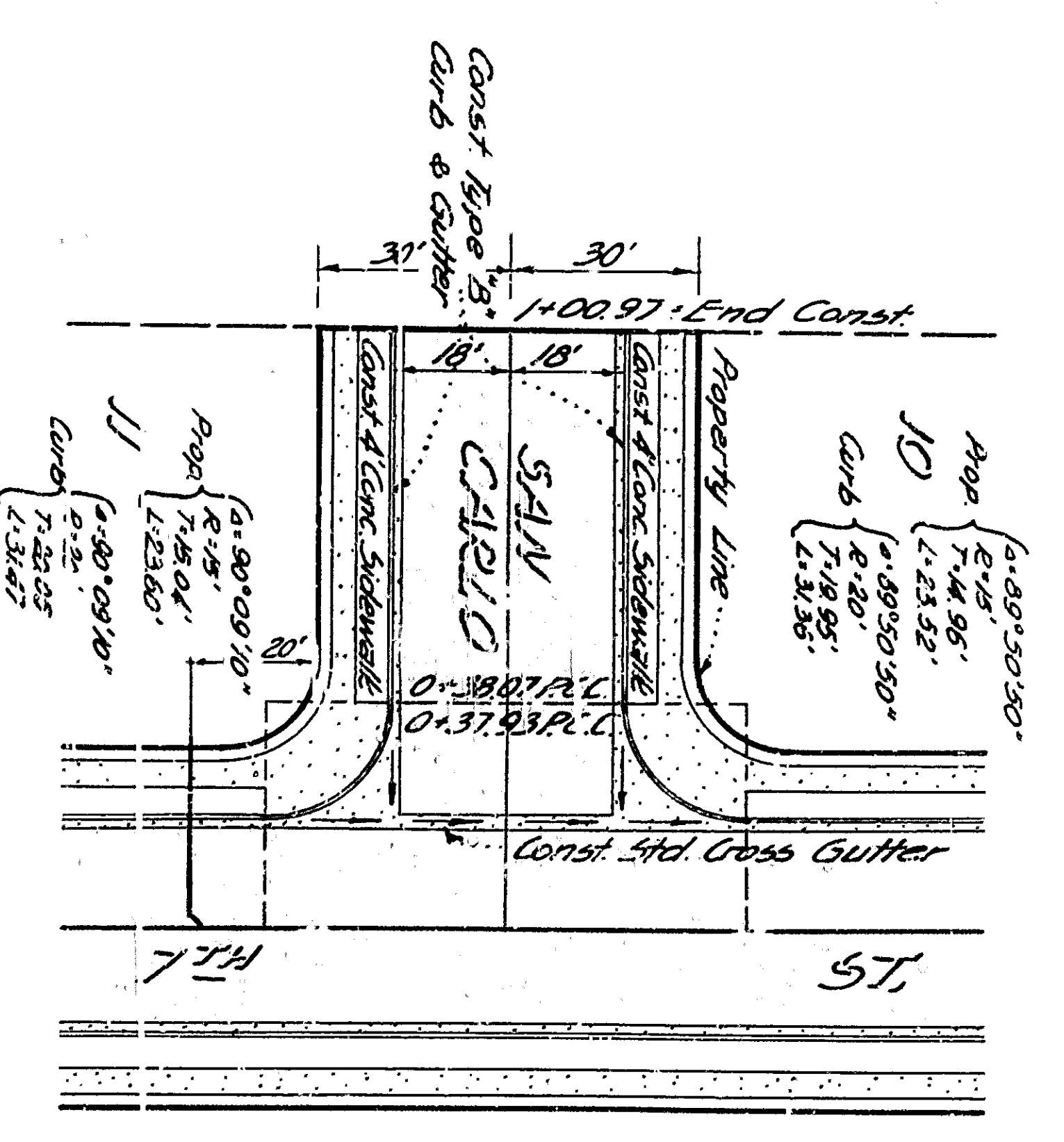


- NOTES:**
1. Materials, forms and covers to be constructed by same contractor.
 2. All work shall be done in accordance with the specifications of the City of San Bernardino.
 3. All work shall be done in accordance with the specifications of the City of San Bernardino.
 4. All work shall be done in accordance with the specifications of the City of San Bernardino.
 5. All work shall be done in accordance with the specifications of the City of San Bernardino.
 6. All work shall be done in accordance with the specifications of the City of San Bernardino.

[Signature]
E. L. BELL

DEPARTMENT OF ENGINEER
CITY OF SAN BERNARDINO
IMPROVEMENT PLANS & PROFILES
TRACT NO. 4905

DESIGNED BY: *[Signature]*
DRAWN BY: *[Signature]*
CHECKED BY: *[Signature]*
REGISTERED CIVIL ENGINEER NO. 9879